

Pasul 5 Montaj Polita Fixa

Se prinde placa (5) de placile (5) cu suruburi (S7)x4

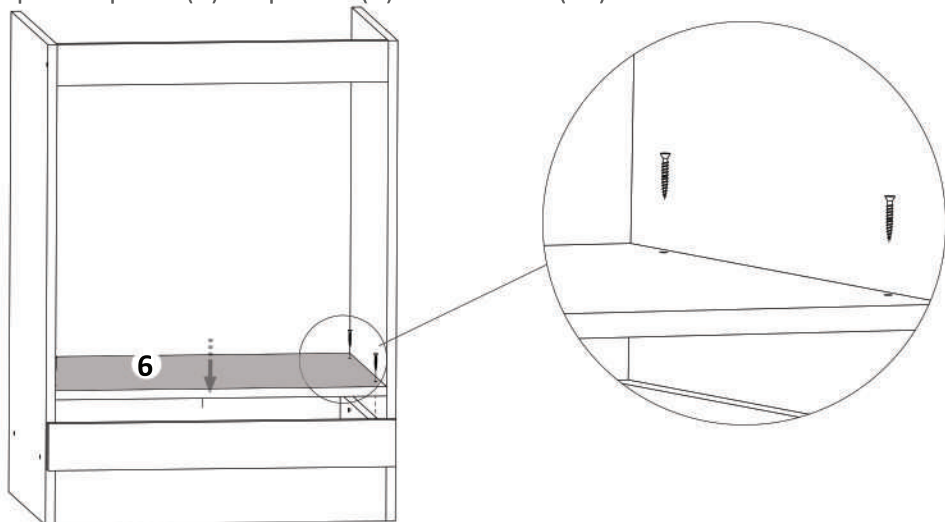

Pasul 6 Montaj Picioare

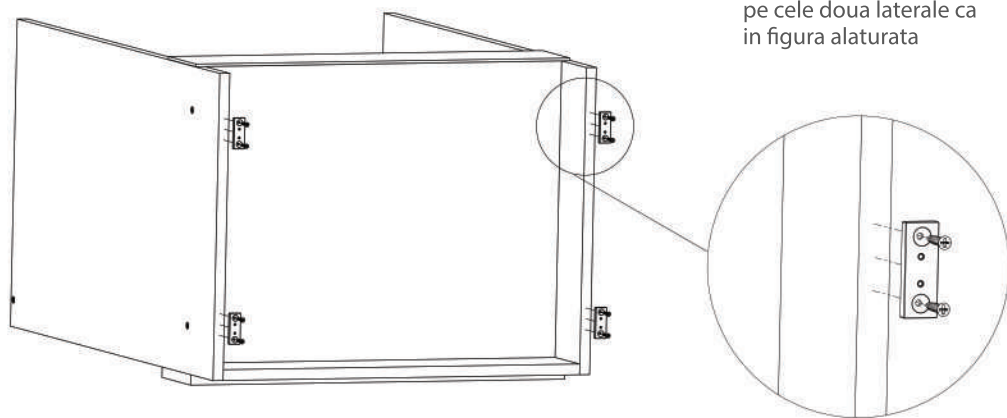

Se fixeaza cu surub (S)x8, pe cele doua laterale ca in figura alaturata

Instrucțiuni montaj: Corp Inferior CUPTOR 600 mm

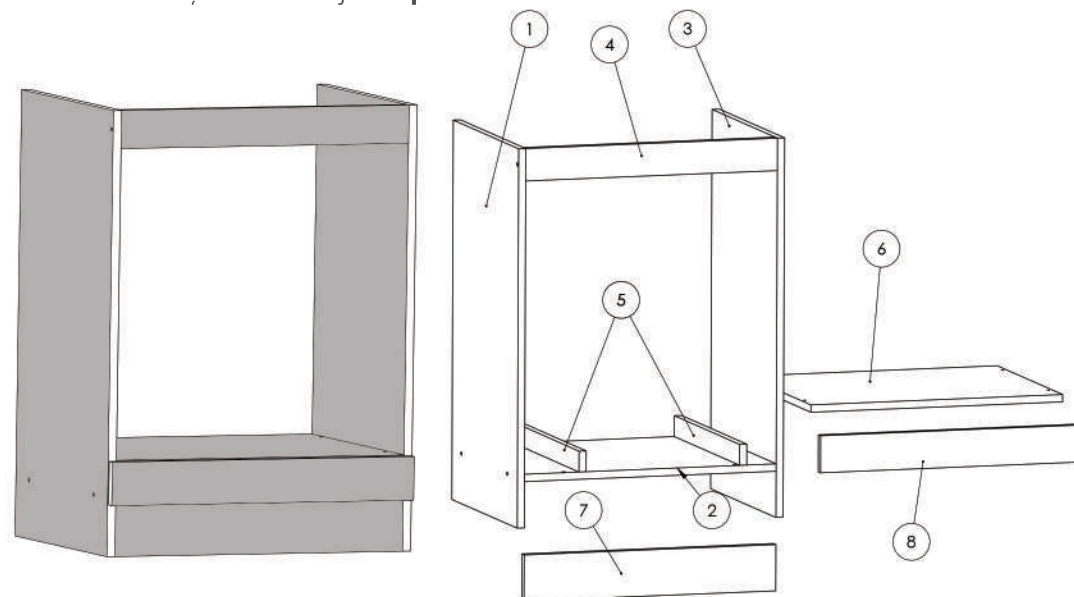

NR. REPER	DETALII	COD REPER	CANTITATE
1	820X456X16	LATERALA ST	1
2	566X456X16	FUND	1
3	820X456X16	LATERALA DR	1
4	566X70X16	LEZENA SUPERIOARA	1
5	45X456X16	LEZENE CUPTOR	2
6	566X456X16	POLITA MOBILA	1
7	566X100X16	SOCLU	1
8	594X80X16	LEZENA FATA CUPTOR	1

ATENȚIE: MONTAJUL NECORESPUNZĂTOR ATRAGE DUPĂ SINE PIERDEREA GARANȚIEI PRODUSULUI



Șurubelniță în cruce sau autofiletantă









Este recomandat ca montajul să fie făcut de minim două persoane



Un ciocan de dimensiune medie

Elemente feronerie:

CONFIRMATOR 50mm C  8	SURUB 3.5X40 S7  4	SURUB 3.5X30 S6  8
SURUB 3.5X16 S3  28	TALPA ALUNECATOARE Ta  4	COLTAR 40X40 Co  4

Pasul 1

Se prind placile (1) si (3) de placile (2) si (4) cu ajutorul confirmatoarelor (C)x6

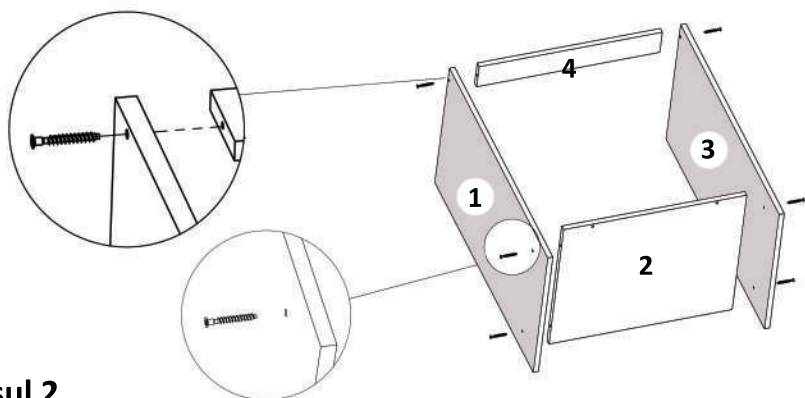

Pasul 2

Se fixeaza placa (7) de placa (2) cu (C)x 2.

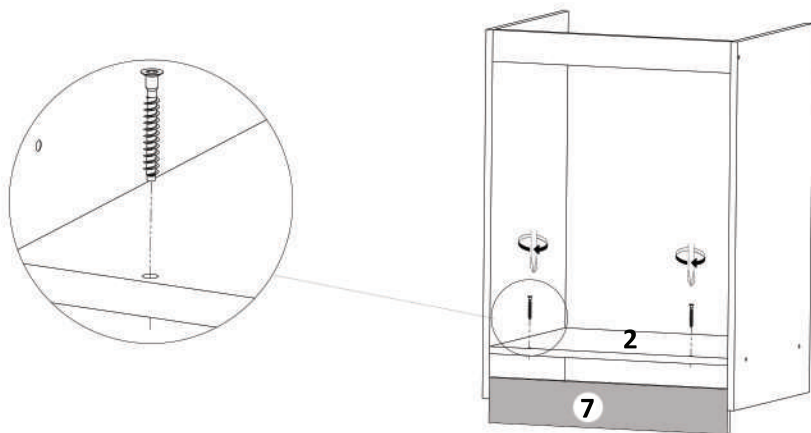

Pasul 3 - Montaj lezene

Se fixeaza placa (5) de placa (1) si (3) cu ajutorul suruburilor (S6)x4

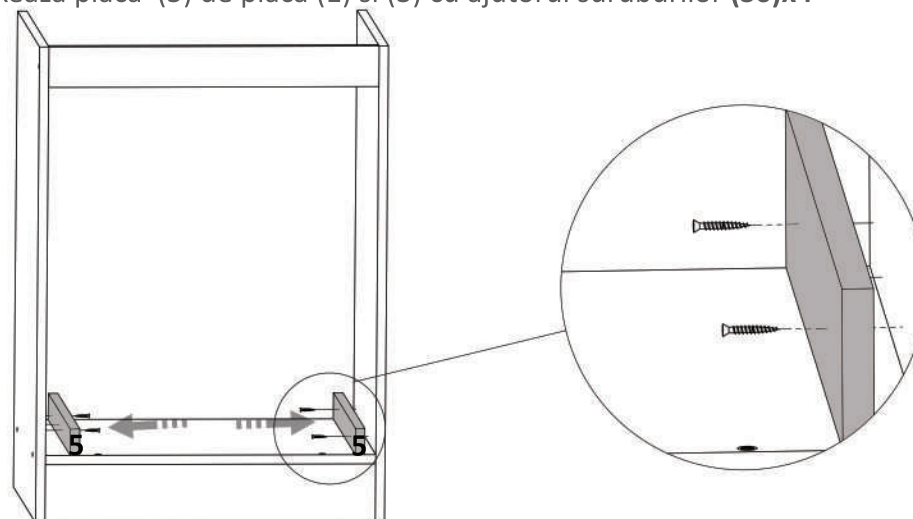

Pasul 4 Montaj lezna fata

Pentru a fixa lezna de sub cuptor (6) se folosesc coltare metalice (CO)x2 si surub (S3)x8 buc, ca in figura alaturata .

